

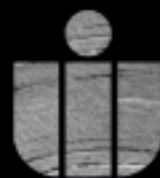

HSB BUCKET ELEVATOR CHAINS

*Durability In The Cement
and Aggregate Industries*



WEBSTER



Webster Heavy HSB Mill Chains for Optimum Performance, Ultimate Durability, and Longer Wear Life

Webster sidebars have precision punched pitch holes. Close tolerance control, consistent pitch, and exact punching improves chain quality and fatigue life.

Webster's Hardened Steel Barrel Rollerless Chain (HSB) is designed for use where conditions require a heavier and more rugged chain. The aggregate and cement industry presents abrasive and corrosive conditions which require superior materials and higher quality construction. This chain quality is designed to service those harsh conditions for maximum wear life. Webster's HSB series chains meet or exceed competitors' hardness and case depth measurements to assure heavy duty service and extended wear.

HSB856B, HSB857A, HSB859B, and HSB864B all have full round construction. This includes the pin and the bushing which are assembled with consistent press fits for improved performance.

Webster's high alloy pins are manufactured with higher case depths to insure greater fatigue resistance.

All Webster's HSB heat-treated bushings are ground for dimensional accuracy to assure consistent press fits, wearability, and ultimate fatigue strength.

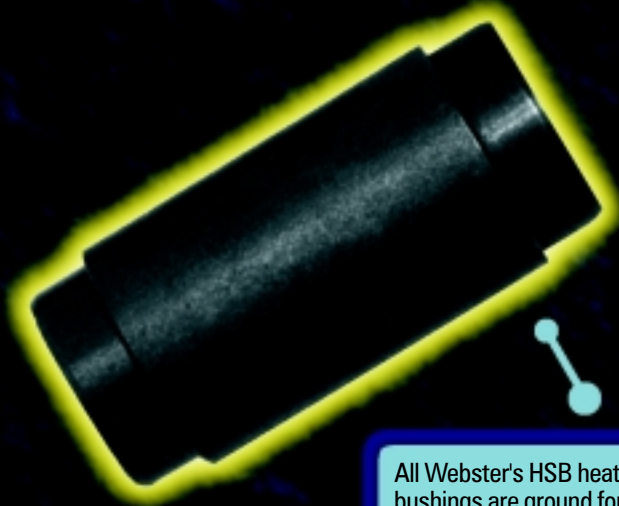
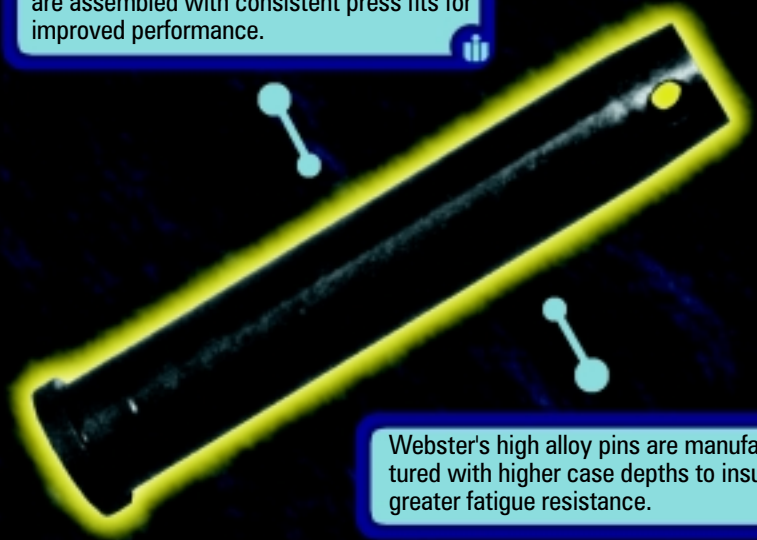
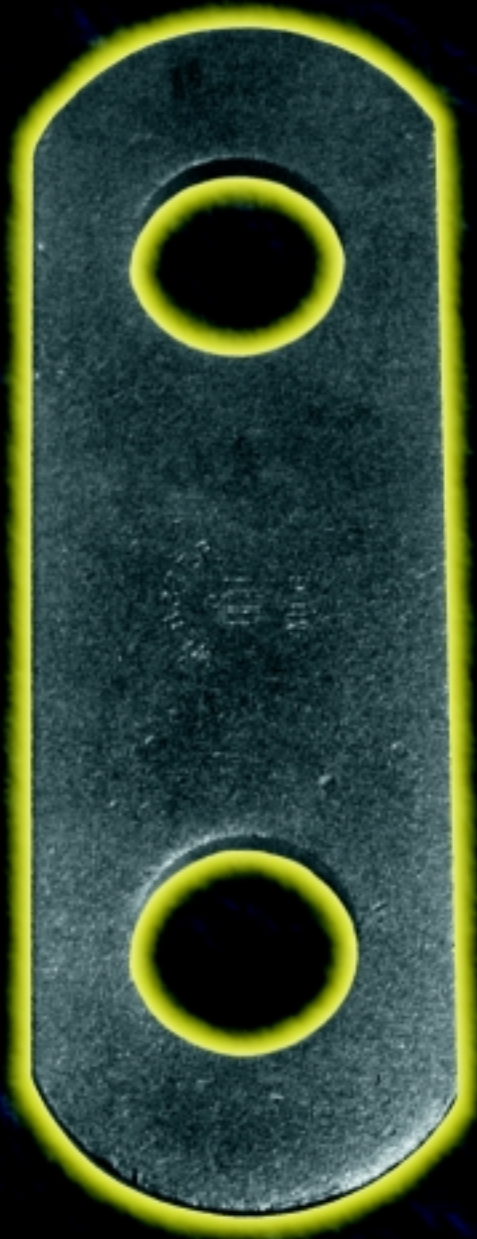

WEBSTER





Heavy Duty HSB Mill Chains

- ▶ HSB856B, HSB857A, HSB859B, and HSB864B have full round pins and bushings with consistent press fits for the ultimate in fatigue strength.
- ▶ For durability in abrasive and corrosive conditions, Webster's HSB chains meet or exceed our competition in hardness and case depth measurements on all parts for improved barrel O.D. and joint wear life.
- ▶ All holes are precision manufactured to assure tight interference fits with mating pins and bushings. Tight tolerance controls assure consistent press fits and optimum chain life.
- ▶ Webster's engineered design, materials and construction now assure PERFORMANCE RELIABILITY for less cost, maintenance and downtime.
- ▶ A variety of attachments are available to meet any application needs.
- ▶ These chains have proved themselves in operation for long life and low maintenance.

CHAIN MATERIAL AND HARDNESS

CHAIN NO.	SIDEBARS		PIN			BUSHING		
	MATERIALS	HARDNESS	MATERIALS	CORE	CASE	MATERIALS	CORE	CASE
HSB857A	1040	269/341 BHN	4140 H	35/40 R _C	57/62 R _C .100/.125 DP	8620 H	35/40 R _C	57/62 R _C .060/.075 DP
HSB859B	1040	269/341 BHN	4140 H	35/40 R _C	57/62 R _C .125/.150 DP	8620 H	35/40 R _C	57/62 R _C .090/.110 DP
HSB864B	1040	269/341 BHN	4140 H	35/40 R _C	57/62 R _C .125/.150 DP	8620 H	35/40 R _C	57/62 R _C .090/.110 DP
HSB856B	1040	269/341 BHN	4140 H	35/40 R _C	57/62 R _C .100/.125 DP	8620 H	35/40 R _C	57/62 R _C .060/.075 DP
HSB956 ^{##}	1040	269/341 BHN	4140 H	35/40 R _C	57/62 R _C .100/.125 DP	8620 H	35/40 R _C	57/62 R _C .060/.075 DP
HSB984	1040	269/341 BHN	4140 H	35/40 R _C	57/62 R _C .125/.150 DP	8620 H	35/40 R _C	57/62 R _C .090/.110 DP
HSB2866*	1040	269/341 BHN	4140 H	35/40 R _C	57/62 R _C .125/.150 DP	8620 H	35/40 R _C	57/62 R _C .075/.090 DP

CHAIN DIMENSIONS

CHAIN NO.	AVERAGE PITCHES INCHES	AVERAGE LINKS IN 10 FT.	RATED WORKING LOAD LBS. ⌘⌘	AVERAGE ULTIMATE STRENGTH LBS.	DIMENSIONS IN INCHES •					
					SIDEBAR THICKNESS & HEIGHT	WIDTH BETWEEN SIDEBARS	⌀ TO COTTERED END	⌀ TO HEAD OR RIVETED END	PIN DIAMETER	BARREL OUTSIDE DIAMETER
HSB857A	6.000	20	14,000	130,000	1/2 X 3 1/4 ††	3	3	2 25/32	1	1 3/4
HSB859B	6.000	20	21,875	200,000	5/8 X 4 †	3 3/4	3 25/32	3 15/32	1 1/4	2 3/8
HSB864B	6.000	17	21,875	200,000	5/8 X 4 †	3 3/4	3 25/32	3 15/32	1 1/4	2 3/8
HSB856B	6.000	20	14,000	100,000	1/2 X 2 1/2	3	3 25/32	2 25/32	1	1 3/4
HSB956	6.000	20	14,000	100,000	1/2 X 3 ☆	3	3	2 27/32	1	1 3/4
HSB984	6.000	17	24,000	200,000	5/8 X 4 ❖	3 3/4	3 25/32	3 15/32	1 3/8	2 1/2
HSB286	6.000	17	27,370	200,000	5/8 X 4 †	4 1/2	4 5/32	2 17/32	1.36	2 3/8

• Have dimensions verified for installation purposes.

⌘⌘ Subject to Service Factors Table 9, Speed Factor Table 11, Cat. #300R, Page A-15.

† Outer side bars 3", inner side bars 4". Can be furnished with both inside and outside side bars of 4".

†† Outer side bars 2 1/2", inner side bars 3 1/4". Can be furnished with both inside and outside side bars of 3 1/4".

☆ OSSB 2 1/2 ❖ OSSB 2 3/4

All common attachments available from stock.

Webster's TS856 Turbo Chain with **TURBO-ABILITY** To Withstand The Harsh Cement Industry

Webster Industries, Inc. is proud to offer TS856, the first in Webster's cement industry chains of the future...TURBO SERIES. This series is so reliable that we back up the product with an exclusive, first in the industry, FOUR YEAR performance guarantee.* The cement industry is a rough and tough industry where normal operations require something better. After years of engineering research Webster has specifically designed a chain for this application. The hot and dry operating conditions with no measurable lubrication, operating in an abrasive environment cried out for something better, something more reliable, Webster's TS856.

The TS856 is produced from certified sidebar quality materials using fine grain particles for insured steel reliability. After precision manufacturing to close tolerances, the parts are tightly controlled through heat treat processes for balanced hardnesses to insure good core strength for toughness, with a high case depth for long wear properties.

Webster's TS856 TURBO SERIES CHAIN has full round pins and bushings with consistent press fits for the ultimate in fatigue strength. Webster's special operation yields holes which are better than pierced and shaved quality to assure tight interference

fits with mating pins and bushings. Tight tolerance controls assure consistent press fits.

For durability in abrasive and corrosive conditions, Webster's TS856 TURBO SERIES CHAIN meets or exceeds our competition in hardness and case depth measurements. All parts are improved for optimum barrel O.D. and joint wear life.

What makes our TS856 TURBO SERIES CHAIN so good? The answer can be summed up in one simple phrase, "We did not just design a good chain, we designed a chain specifically for the cement industry." TS856 is exactly what the cement industry wanted, not just an average chain, but something unique for their particular industry.

Webster's TS856 design, materials and construction now assure performance reliability for less cost, maintenance and downtime.

A variety of attachments are available to meet your unique application needs plus TURBO SERIES CHAINS are completely interchangeable with any previous designs.

TURBO SERIES CHAINS are the first in the industry that are backed by a FOUR YEAR performance guarantee.*

CHAIN DIMENSIONS

CHAIN NO.	AVERAGE PITCHES INCHES	AVERAGE LINKS IN 10 FT.	RATED WORKING LOAD LBS. ☒ ☒	AVERAGE ULTIMATE STRENGTH LBS.	DIMENSIONS IN INCHES •					
					SIDEBAR THICKNESS & HEIGHT	WIDTH BETWEEN SIDEBARS	☒ TO COTTERED END	☒ TO HEAD OR RIVETED END	PIN DIAMETER	BARREL OUTSIDE DIAMETER
TS856	6.000	20	14,000	150,000	1/2 X 3	3	3	2 27/32	1	1 3/4

W E B S T E R
TURBO
CHAIN

GUARANTEED PERFORMANCE WITH WEBSTER'S EXCLUSIVE FOUR YEAR PERFORMANCE GUARANTEE

Webster Industries, Inc. guarantees the Turbo Cement Mill Chains when properly installed, maintained, and applied, without alteration, in a cement mill bucket elevator, will not fail because of any defect in material or workmanship for four (4) years. In the event of any failure, the chain or defective part, at Webster's option, will be replaced, in accordance with the following schedule.

- 1st Year - Chain Or Part Replaced At No Charge
- 2nd Year - Chain Or Part Replaced At 40% Of Original Price
- 3rd Year - Chain Or Part Replaced At 70% Of Original Price
- 4th Year - Chain Or Part Replaced At 90% Of Original Price

Remedy under this guarantee is between the user and Webster and no other person. Webster's liability is limited to the replacement of the defective product, and user waives all other remedies, including but not limited to, all rights to consequential, special or incidental damages, including but not limited to damages resulting from personal injury, death or damage to or loss of use of property. This guarantee commences upon the date of shipment.

SELLER MAKES NO OTHER WARRANTY OF ANY KIND WHATEVER, EXPRESS OR IMPLIED. ALL IMPLIED WARRANTIES OF MERCHANTABILITY AND FITNESS FOR A PARTICULAR PURPOSE ARE HEREBY DISCLAIMED BY THE SELLER AND EXCLUDED FROM THIS AGREEMENT.

All common attachments available from stock.

WEBSTER



Standard Duty HSB Mill Chain

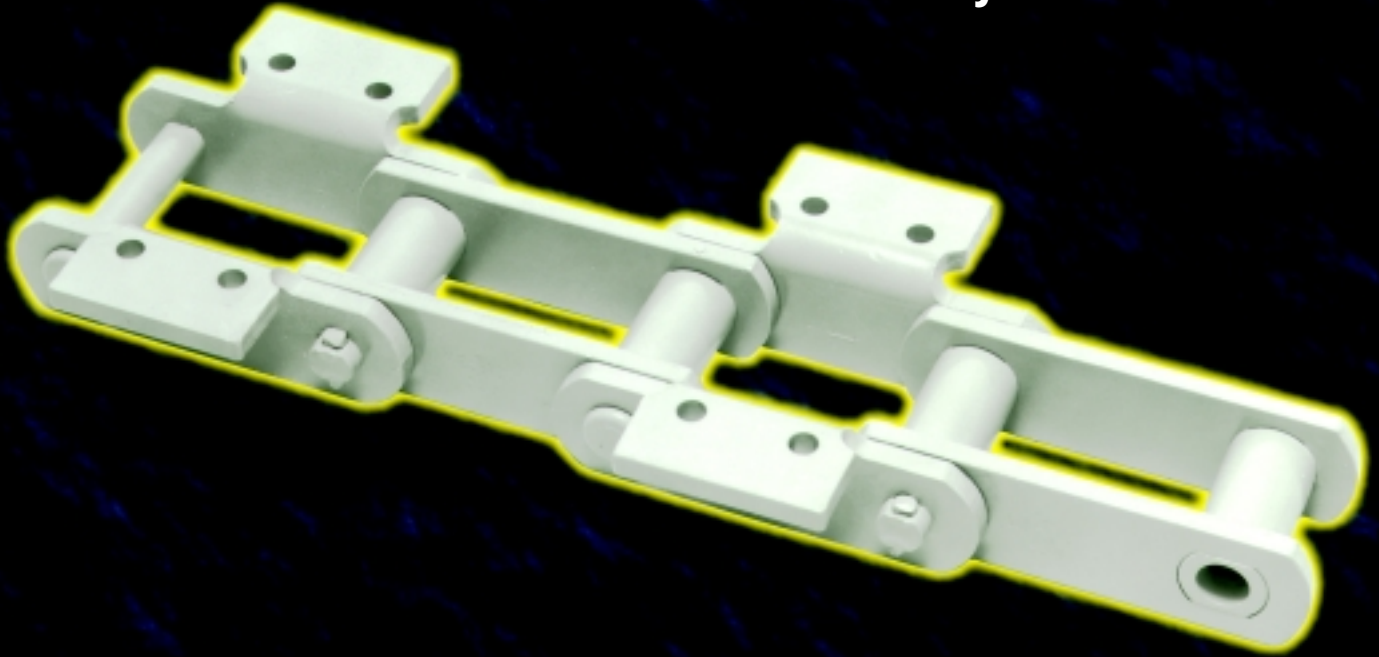

The Hardened Steel Bushed Chain is designed as a substitute for combination chain where conditions require a heavier and more rugged chain.

Material - Sidebars are made of medium carbon fine grain steel. Pins are alloy steel and heat treated. The barrels are carbon or alloy steel and case hardened. Lube holes are standard on some chains and available on request.

Assembly - Cottered construction is recommended for elevators and conveyors. Riveted construction is recommended for woodyards and sawmills. Riveted or

cottered construction must be specified. Chain pins will be staggered, except on HSB131 and HSB188.

Interchangeability - This chain is interchangeable with other standard makes of corresponding sizes and numbers.

Application - These chains are used for bucket elevators, woodyard conveyors, elevators operating under gritty and abrasive conditions and other types of conveyors. These chains have proved themselves in operation for long life and low maintenance.

CHAIN DIMENSIONS

CHAIN NO.	AVERAGE PITCHES INCHES	AVERAGE LINKS IN 10 FT.	RATED WORKING LOAD LBS. ☒ ☒	AVERAGE ULTIMATE STRENGTH LBS.	DIMENSIONS IN INCHES •					
					SIDEBAR THICKNESS & HEIGHT	WIDTH BETWEEN SIDEBARS	☒ TO COTTERED END	☒ TO HEAD OR RIVETED END	PIN DIAMETER	BARREL OUTSIDE DIAMETER
HSB188	2.609	46	2,730	25,000	$1/4 \times 1 1/8$	$1 1/16$	$1 11/32$	$1 7/32$	$1/2$	$7/8$
HSB131	3.075	39	4,380	40,000	$3/8 \times 1 1/2$	$1 1/4$	$1 13/16$	$1 5/8$	$5/8$	$1 1/4$
HSB102B	4.000	30	6,290	40,000	$3/8 \times 1 1/2$	$2 1/8$	$2 3/16$	$2 1/16$	$5/8$	1
HSB102 $1/2$	4.040	30	7,700	50,000	$3/8 \times 1 3/4$	$2 3/16$	$2 3/8$	$2 1/8$	$3/4$	$1 3/8$
HSB111	4.760	25	8,850	50,000	$3/8 \times 2$	$2 5/8$	$2 19/32$	$2 11/32$	$3/4$	$1 7/16$
HSB110	6.000	20	6,290	40,000	$3/8 \times 1 1/2$	$2 1/8$	$2 3/16$	$2 1/16$	$5/8$	$1 1/4$
HSB833	6.000	20	8,850	50,000	$3/8 \times 2$	$2 5/8$	$2 19/32$	$2 11/32$	$3/4$	$1 7/16$
HSB844	6.000	20	9,200	65,000	$1/2 \times 2$	$2 1/2$	$2 23/32$	$2 17/32$	$3/4$	$1 1/8$
HSB150PLUS	6.050	20	15,100	100,000	$1/2 \times 2 1/2$	$3 3/8$	$3 7/32$	$3 1/32$	1	$1 3/4$

• Have dimensions verified for installation purposes. ☒ ☒ Subject to Service Factors Table 9, Speed Factor Table 11, Cat. #300R, Page A-15.

All common attachments available from stock.



MADE IN THE USA

Specify Webster Heavy HSB Mill Chains for durability and greater wear life in the aggregate industry!

▶ A Challenge to Compare

Webster is as solid as its 125 years. With constant changes in other suppliers domestic and abroad, you can always rely on Webster's USA made products to consistently provide you with precision quality products at competitive market prices.

▶ Experience and Knowledge in the Aggregate and Cement Industries

For decades Webster has been a proven leader in the cement and aggregate material handling industries. Our experience and knowledge provide our customers the ultimate in chain quality.

▶ Quality and Precision in Chain Construction and Manufacturing

Webster provides only the highest standards in chain quality, backed by warranties, and over a century of successful product performance. Since 1998, Webster's ISO 9001 Registered Quality Management System insures consistent quality throughout our entire product line.

▶ Dependability Guaranteed

Webster products are fully guaranteed and warranty information is available with each order. As with any Webster product our name is synonymous with quality and service.

▶ On-Time Delivery

With three plants throughout the USA set up for stock and quick-custom processing, our emphasis is on fast turn-around time to prevent or reduce customer downtime and costs. Our 200,000+ feet of stock chains insure the highest customer satisfaction.

▶ Competitive pricing on Stock and Custom Products

Consistent, competitive pricing is routine at Webster, because chain is Webster's specialty and primary product. Contact YOUR customer service representative for current price and availability.

▶ Engineering and Technical Service Before and After the Order

Webster's engineering and technical staff specializes in chain designed for conveying systems. Our service is just as important after the order, as before.

▶ Reliable and Knowledgeable National Distributor Network

Webster's national distributor network extensively covers the USA from coast to coast, and is reputable and knowledgeable in material handling and power transmission products through years of supplying Webster chains and vibrating conveyors.



WEBSTER INDUSTRIES, INC.

800-243-9327

325 Hall St.
Tiffin, OH 44883

800-243-9327 | 419-447-8232
FAX: 419-448-1618

www.websterchain.com

9620 Southwest Herman Rd.
P.O. Box 519
Tualatin, OR 97062

800-243-9327 | 503-692-4818
FAX: 503-692-8268

E-mail: sales@websterchain.com

3800 Second St. (39301)
P.O. Box 1747
Meridian, MS 39302

800-243-9327 | 601-482-0183
FAX: 601-693-5918

